

# Mini S

Grasp the world with the pocket Mini S

## User's manual

The physical appearance of the product may vary.  
Apologize for absence of advanced notice if specifications of  
the product differentiate to improve its performance

## Important safety notice

Your projector have been designed and tested according to the latest safety standards of information technology devices. However, to ensure your safety when operating the projector, it's of extreme importance to follow the user's manual and labels on the product.

### 1.Safety notice

1. Please read the user's manual before operating the projector, and keep the manual for future reference.
2. Please do not stare straight into the projector lens while operating as it might be harmful for your visions
3. Please note that the electric voltage may be volatile in certain countries. The projector could operate normally under the range of voltage from 100V to 240V. But operation could terminate when encounter loss of power and/or +/- 10V. It is recommended to use power stabilizer or Uninterruptible Power Supply(UPS) when the above scenarios apply.
4. Please do not alter or replace the battery without professional help
5. Do not place any types of liquid on top or near the projector. In case a splash occurs, please shut the power immediately and contact the service center.
6. Please do not blockade the ventilation, as it might overheat the device and potentially cause a fire.
7. Please do not operate the device in below environments. Extreme brightness, dirty, dusty, strong magnetic fields
8. Please do not jam the projector lens as it may overheat and cause a fire.
9. Please consult professional help when repairing the device.

### 2.List of contents

Mini S wifi portable projector. Adapter, video chords, supporting stand, user's manual, warranty card.

## Warranty card

Product name			
Model No.		Unit No.	
Purchase date		Quantity	
Occupation			

#### Warranty declaration

- Please keep the warranty card for proof of warranty service
- Effective one year from the purchase date
- Will provide free of charge warranty service for products that were under normal operation

#### Conditions inapplicable for warranty service

- Irregular operations that result in damage of the product
- Unauthorized technical alteration of the product
- Modified or mismatching serial numbers
- Accidental or intentional undermining of the product

Products that are warranty expired or have conditions inapplicable for warranty services can be repaired for a fee.

### 3. Product introduction

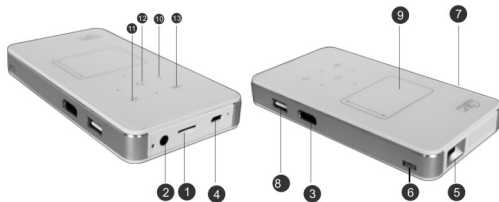

1. TF card socket
2. Power socket
3. HDMI cable
4. USB
5. Lens
6. Focus adjustment
7. Power key
8. USB socket
9. Capacitive touch panel
10. Scroll up
11. Return
12. OK key
13. Home key

8: Surf the Internet. Click on the IE icon from the main interface

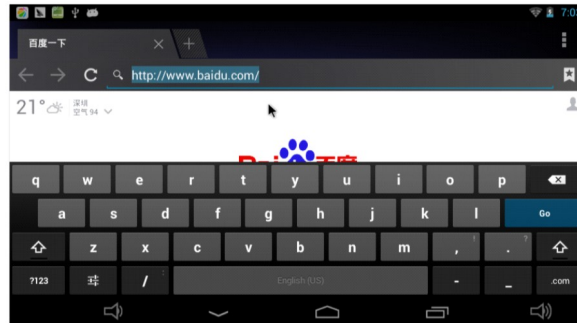

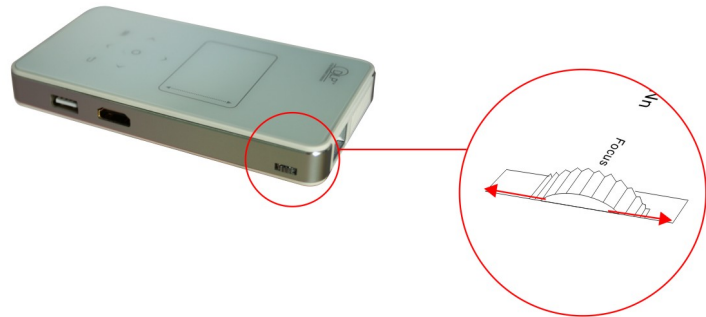

Please adjust the focus wheel back and fourth in case the projection appears to be blurry.

7:Local play. Click on file management from the main interface as illustrated, select the proper location and play.

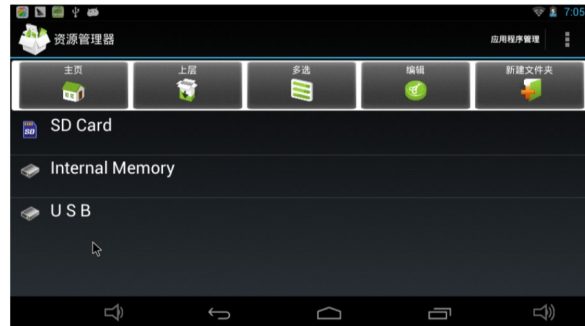

CPU chipset: Quad-core Rockchip Rk3188, ARM Cortex-A9, 28nm power efficient  
 GPU processor: Quad-Core Mali 400 Mp4 533mhz  
 RAM: DDR31GB  
 ROM: 8GB high-speed Nano Flash (16GB optional)  
 WIFI: Dual band 2.4 Ghz WIFI module. High-speed connection. Could reach up to 65MBPS under 802.11N mode  
 Blue tooth: BT 4.0 Broadcom Bcm 40183. Top speed 3MBPS  
 LED: DLP R.G.B authentic coloring  
 Brightness: 70 LM  
 Physical resolution: 854\*480  
 Maximum resolution(compatible): 1920\*1080 High Def 1080P  
 LED life: > 30000 hours  
 Contrast: 1000:1  
 Screen height/width ratio: 16:9 (4:3 compatible)  
 Image size: Max 120 inch (1M=37.8" )  
 Projecting distance: 18cm - 300cm  
 Focus adjustment: Manual  
 HDMI hub: HDMI2.0  
 USB hub: USB2.0  
 Micro SD hub: Micro(TF)  
 Power hub DC3.5: DC3.5 Input AC:100-240V,Output DC: 9V/2A  
 Audio hub AD3.5: Supports AD3.5 compatible setups  
 Speaker: Internal 8W surround sound speakers  
 Battery: Internal large capacity rechargeable Lithium battery  
 Infrared remote: Supports infrared controller  
 Wireless: Supports wireless 2.4G mouse and keyboard  
 Memory: supports Micro SD(TF) up to 32GB  
 File viewing: Embedded WPS OFFICE software, supports Word, Excel,pdf, ppt and etc  
 Screen synchronization: Supports Apple's Air play, and Android's miracast  
 Audio: Supports MP1/MP2/MP3/WMA/WAV/OGG/OGA/APE/FLAC/AAC/M2A/3GPP and other formats  
 Video: Supports MPEG1/2/4.H.264/AVC/MVC/Vc1XVID/DIVX/REAL VIDEO/8/9/10 Vp6/Mp4/Mov and other formats  
 Picture format: Supports JPEG/BMP/GIF/PNG and etc  
 Language: Supports simplified/traditional Chinese, English, Russian, French, German, Spanish, Portugese, Italian and etc  
 Dimensions: 142\*73\*17MM

1. Go to Wi-Fi in settings, select the preset device name and connect with password: 12345678

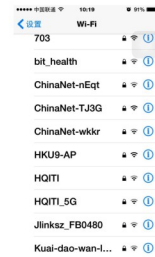

2. Connect the portable projector to wireless network, this can be skipped if no wireless network available.  
3. Scroll from the bottom to activate Air Play

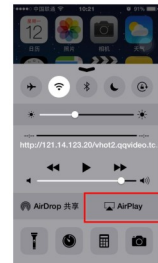

4. Select the proper Air play device after connection has been established



### System interface

1. Power on by pressing the power button. The lightbulb will be light and will hear the power-on sound. The below illustration shows the system interface after successfully powered on.



### 5: Air Play screen synchronization



## 1:Connect to WIFI

1:Click on system settings as illustrated

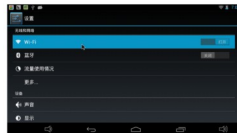

2:Turn on WIFI, select your WIFI and input password



4:Under Android 4.2, select screen sync in settings as illustrated.



2:Screen synchronization: Click on wireless screen sync and select the sync method



7

3 :Android screen synchronization

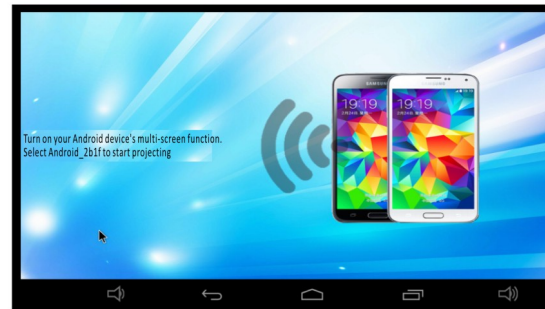

8